

UNI-SPRAY "MARK I" ADJUSTABLE NOZZLE ASSEMBLY

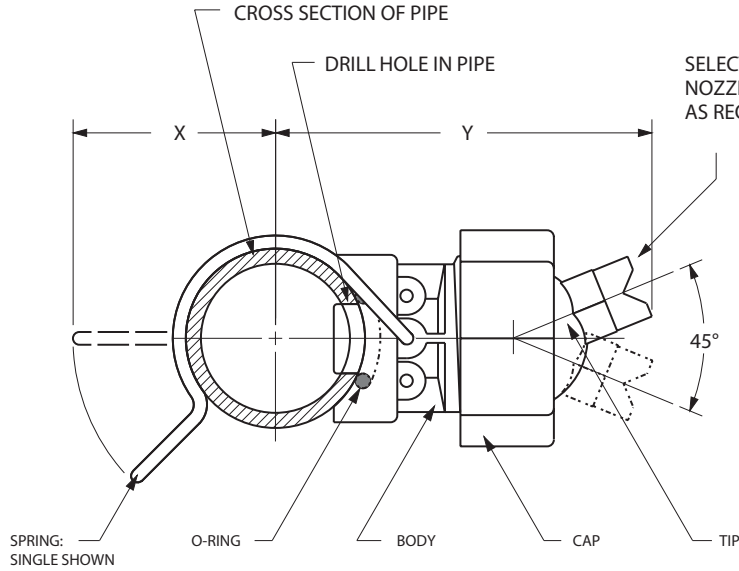

Major Dimensions

(inch)		X	Y
1"	Pipe	1.70	3.21
1-1/4"	Pipe	1.89	3.43
1-1/2"	Pipe	2.02	3.56
2"	Pipe	2.25	3.75

(mm)		X	Y
25 mm	Pipe	43.2	81.5
32 mm	Pipe	48.0	87.1
40 mm	Pipe	51.3	90.4
50 mm	Pipe	57.2	95.3

ALSO AVAILABLE WITH DOUBLE SPRINGS
FOR PRESSURES FROM 60 TO 150 PSI
(4.1 TO 10.3 BAR)

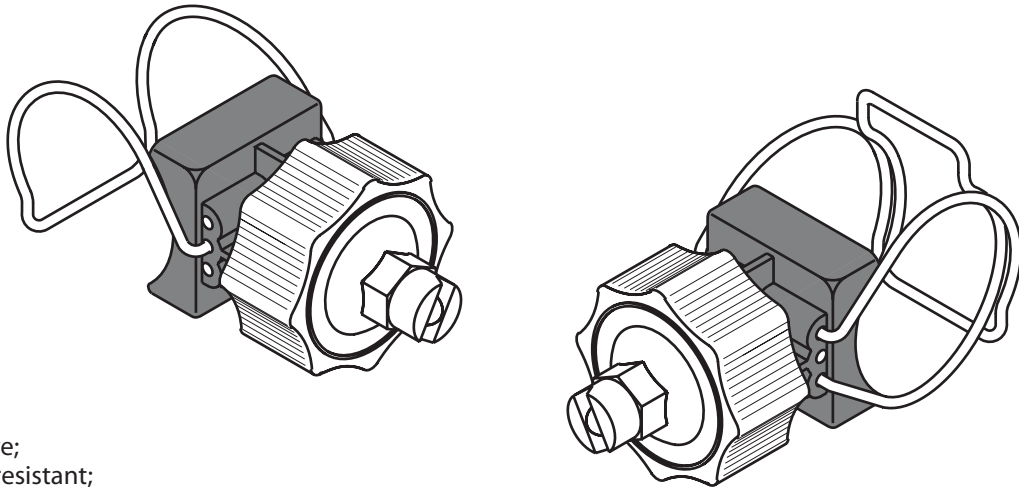

Features:

- inexpensive;
- corrosion resistant;
- impervious to most chemicals;
- good heat resistance;
- injection molded from custom blended polypropylene;
- standard with Single Spring Clamp;
- optional Double Spring Clamps for pressures over 60 psi (4.0 bar);
- resists clogging;
- directional adjustment of nozzle tip anywhere within 45°;
- tips available in Full Cone, Hollow Cone or Flat Spray configurations;
- tips available with threaded ball Connection in 1/8, 1/4, 3/8 and 1/2 inch NPT or BSP threads;
- nozzle bodies available in three spigot sizes to fit either 21/32", 9/16" or 19mm diameter holes on the riser.

"MARK I" ADJUSTABLE NOZZLE ASS'Y ORDERING INSTRUCTIONS

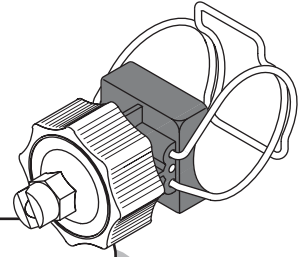

How To Order A Mark I Adjustable Nozzle Assembly:

The complete Part Number tells us exactly what assembly you want.

For example, let's say that you want to order a Mark I Adjustable Nozzle Assembly to fit on a 1-1/2 inch pipe, with a single spring, and with a 65° Flat Spray Nozzle Tip that will deliver 3.5 gpm at 30 psi:

Step 1:

The Part Number begins with 'UNI' and the Pipe Size, as follows:

'UNI 100' = 1 inch pipe
'UNI 125' = 1-1/4 inch pipe
'UNI 150' = 1-1/2 inch pipe
'UNI 200' = 2 inch pipe

... so in our example, we would have so far...

'UNI 150 ...'

Step 2:

Select a Nozzle Tip from the tip selection page and add the Tip Number to the Part Number, so in this example we now have...

'UNI 150 6540...'

Note that the 'UNI' in front of the Tip Number is dropped when the Tip Number is incorporated into the Assembly.

Step 3:

Add 'M1' to denote the Style, which is standard with Single Spring. If it was to have a Double Spring, the Style would be 'M1 D'.

So, in our example, we end up with...

'UNI 150 6540 M1'

Note: Our standard Nozzle Assemblies are designed with spigots to fit risers with 21/32" diameter drilled holes. We also manufacture assemblies with smaller spigots for 9/16" diameter holes. To specify the 9/16" spigots, simply change the 'UNI' in the part number to 'SS' for 'Small Spigot'. In that case, using the example above, the part number would become...

'SS 150 6540 M1'

UNI-SPRAY SYSTEMS INC.

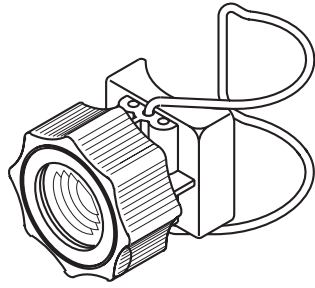

M1 Assembly (No Tip) Single Clamp:
 UNI-100 BSOC
 UNI-125 BSOC
 UNI-150 BSOC
 UNI-200 BSOC

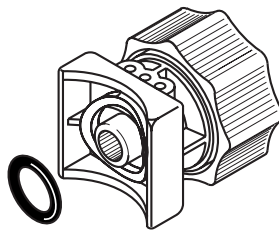

M1 Body, Cap, and "O" Ring:
 UNI-100 BCO
 UNI-125 BCO
 UNI-150 BCO
 UNI-200 BCO

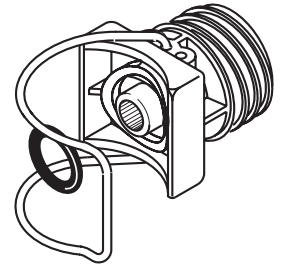

M1 Body, Single Clamp and "O" Ring:
 \UNI-100 BSO
 UNI-125 BSO
 UNI-150 BSO
 UNI-200 BSO

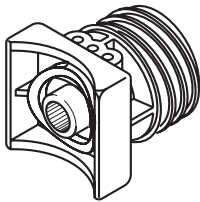

M1 Body only:
 UNI-100 B
 UNI-125 B
 UNI-150 B
 UNI-200 B

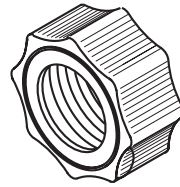

M1 Cap:
 UNI RC

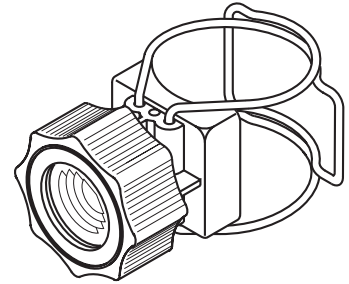

M1 Assembly (No Tip) Double Clamp:
 UNI-100 BSOC D
 UNI-125 BSOC D
 UNI-150 BSOC D
 UNI-200 BSOC D

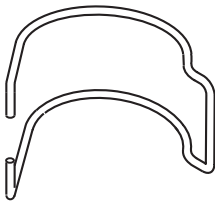

M1 or M2 Single Clamp:
 UNI-100 SS
 UNI-125 SS
 UNI-150 SS
 UNI-200 SS

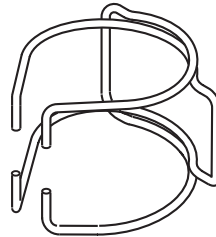

M1 or M2 Double Clamp Set:
 UNI-100 SS plus UNI-100 DW
 UNI-125 SS plus UNI-125 DW
 UNI-150 SS plus UNI-150 DW
 UNI-200 SS plus UNI-200 DW



M1 or M2 "O" Ring:
 UNI ODM EPDM
 UNI OVT VITON

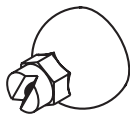

Nozzle Tip:

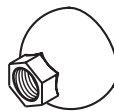

Threaded Ball:

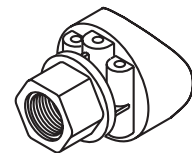

M2 Adapter Body:
 UNI-100 M2 B
 UNI-125 M2 B
 UNI-150 M2 B
 UNI-200 M2 B